



LAUBE 823 LITENING VARIABLE

MODEL #LA82310101 JANUARY 1, 2005



KIM LAUBE & CO INC

1 Name Plate Assembly

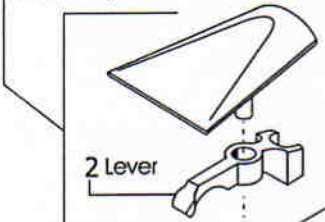

8 Set Screws (4PI)

9 Enduro II Drive Shaft Bearing

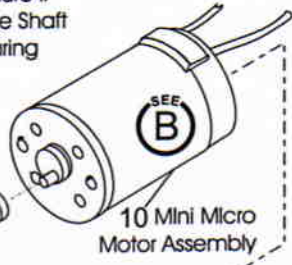

10 Mini Micro Motor Assembly

3 Latch

4 Hinge

5 Hinge Screws

6 Litening Name Plate Screw

7 Housing



12 Pot Control (With On-Off-Sw)

14 Switch Cap (Litening)

21 Bale Hanger
20B Power Cord (only)
20A Power Cord (w/ Transformer)
19 Black Knob (POT)
18 Nut (Pot Control)
17 Washer
16 Strain Relief
15 ID Plate (V spd Mini Micro)

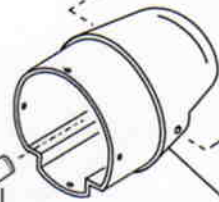

13 KLB002 Circuit Board Assembly (Variable Speed)

11 Solid Spacer (micro)

34 Mini Micro Motor Brush Assembly (Original Cantilever)

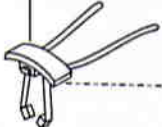

32 Motor End Bell (Micro)

36 Armature Bearing



33 Motor Mount Screw

32 Motor End (Micro)



35 Mini Micro Motor Brush Assembly (New Cartridge)

31 Motor Field (Micro)

30D Armature Spacer (Heavy)

30C Armature Spacer (Medium)

30B Armature Spacer (Fine)

30A Armature Spacer (Ultra Fine)

29 Armature Washer (Plastic)

28 Armature (Micro)

27 Enduro Armature Bearing

26 Enduro Armature Spring

25 Micro Motor Front Plate

24 Oil Slinger (Plastic)

23 Drive Shaft Post

22 Drive Shaft Lock Screw

(Clipper Housing)



37 Brush Spring (8000) Right Silver

39 Motor Brush (Micro) Replacement (New Style)

38 Brush Spring (8000) Left Gold

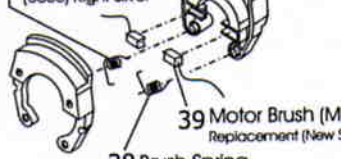

Kim Laube & Co Inc
2221 Statham Blvd
Oxnard, CA. 93033
800-451-1355 805-240-1300
805-240-1301 FAX
www.kimlaubeco.com



LAUBE 823 LITENING VARIABLE

MODEL #LA82310101 JANUARY 1, 2005



| | ITEM | PART# | REQD | DESCRIPTION |
|-----|--------------|--------------|--|---|
| A | 1 | SE5110030 | 1 | Litening Name Plate Assembly (with Lever) |
| | 2A | SE5110040000 | 1 | Lever Last" Clipper Lever |
| | 2B | SE5135032 | | Lever Last" Clipper Lever 25 Pack |
| | 2C | SE5135042 | | Lever Last" Clipper Lever 100 Pack |
| | 3A | SE5110020 | 1 | Clipper Latch (Litening) |
| | 3B | SE5110025 | | Clipper Latch ((Litening)) 50 Pack |
| | 4A | SE5100050000 | 1 | Hinge Assembly (Ribbed) |
| | 4B | SE5100100000 | | Hinge Assembly (Ribbed) 50 Pack |
| | 5 | SE5100090000 | 2 | Hinge Screw (Litening) |
| | 6 | SE5100020000 | 2 | Name Plate Screw |
| | 7 | SE7400010001 | 1 | Litening Housing |
| | 8 | SE7100090000 | 4 | 2/56 X 1/4 Socket Set Screws |
| | 9a | SE5141000000 | 1 | Enduro II Drive Shaft Bearing |
| | 9b | SE5110000 | | Enduro II Drive Shaft Bearing 50 Pack |
| | 10 | SE7300030000 | 1 | Mini Micro Motor Assembly |
| | 11 | SE7210060000 | 1 | Solid Spacer (Micro) |
| | 12 | SE7500010000 | 1 | Pot Control (with On / Off Switch) |
| | 13 | SE7300100001 | 1 | Klb 002 Circuit Board Assembly |
| | 14 | SE7400110001 | 1 | Switch Cap (Litening) |
| | 15 | UA11706 | 1 | ID Chip Mini Micro (2 Speed) |
| | 16 | SE5230010000 | 1 | Power Cord Strain Relief |
| 17 | SE5220060000 | 1 | Washer (Pot Control) | |
| 18 | SE5500250000 | 1 | Nut (Pot Control) | |
| 19 | SE5600020000 | 1 | Black Knob (Pot Control) | |
| 20A | SE50266303 | 1 | Transformer 110/220v 50-60Hz USA Plug (18' Cord) | |
| 20B | SE5230000000 | 1 | Power Cord Assembly (Quick Disconnect) | |
| 21 | SE7200020000 | 1 | Bale Hanger (mini series) | |
| B | 22 | SE5120020000 | 2 | Drive Shaft Lock Screw |
| | 23 | SE5120010000 | 1 | Drive Shaft Post |
| | 24 | SE5121080000 | 1 | Oil Slinger Clear 12 Pack |
| | 25 | SE7140010000 | 1 | Motor Front Plate (Mini Micro) |
| | 26 | SE5120040000 | 1 | Enduro Armature Washer Spring |
| | 27 | SE5140040000 | 1 | Enduro Armature Bearing |
| | 28 | SE7120060000 | 1 | Armature (Mini Micro) |
| | 29 | SE5120070000 | 1 | Armature Washer (Plastic) |
| | 30A | SE5120080000 | 1 | Armature Spacer (Ultra Fine - As Needed) |
| | 30B | SE5120090000 | 1 | Armature Spacer (Fine - As Needed) |
| | 30C | SE5120100000 | 1 | Armature Spacer (Medium - As Needed) |
| | 30D | SE5120110000 | 1 | Armature Spacer (Heavy - As Needed) |
| | 31 | SE7120120000 | 1 | Motor Field For Mini Micro Clipper |
| | 32 | SE7121040000 | 1 | Motor End Bell (Mini Micro) |
| 33 | SE5100080000 | 2 | Motor Mount Screw | |
| C | 34 | SE7121010000 | 1 | Mini Micro Motor Brush Assembly (Original Cantilever) |
| | 35 | SE5120150000 | 1 | Mini Micro Motor Brush Assy (New Cartridge) |
| | 36 | SE5120050000 | 1 | Armature Bearing |
| D | 37 | SE7121010002 | 1 | Brush Spring Micro Silver Right |
| | 38 | SE7121010003 | 1 | Brush Spring Gold Micro Left |
| | 39 | SE5121010001 | 2 | Motor Brush Contact (New Style) |

Accessories

| | |
|------------|---|
| LA50266100 | Universal Transformer 100-240v 50-60Hz (Quick Disconnect) |
| SE5135002 | Lever Last" 6 Pack (CLIPPER) |
| SE5135025 | Lever Last" 6 Pack (CLIPPER) 25 Pack |
| SE5135100 | Tune Up Kit (Litening Clipper) |
| SE5135110 | Tune Up Kit (Litening Clipper) 25 Pack |
| SE5141000 | Laube Clipper Grease (1oz bottle) |
| SE5142000 | Scented Clipper Oil (1oz bottle) |